

**Contact Us:**

Email: [sales@premier-metals.com](mailto:sales@premier-metals.com)

Phone: 310-532-6185

[www.premier-metals.com](http://www.premier-metals.com)



**NOTES ON SYMBOLS**

" $\bar{y}$ " = LOCATING DIMENSIONS FOR AXIS XX-YY.

$I_{xx}$  (and  $I_{yy}$ ) = MOMENT OF INERTIA ABOUT XX and YY.

$p_{xx}$  (and  $p_{yy}$ ) = RADIUS OF GYRATION ABOUT XX and YY.

	NOMINAL DIMENSIONS				AREA	SECTION ELEMENTS					
	A	B	T	R		$\bar{y}$	$I_{xx}$	$I_{yy}$	$p_{xx}$	$p_{yy}$	
AND or AMS Extrusion Number	Inches				Square Inches	Inch	Inches <sup>4</sup>		Inch		
AND10137-0601	.750	.375	.050	.094	.0727	.106	.0009	.0060	.111	.286	
AND10137-0602		.500	.050		.0852	.153	.0020	.0075	.152	.296	
AND10137-0603		.625	.050		.0977	.204	.0037	.0090	.195	.304	
AND10137-0604		.875	.625	.063	.125	.123	.207	.0045	.0109	.190	.298
AND10137-0605			.875	.063		.155	.315	.0117	.0147	.275	.308
AND10137-0606			.875	.094		.220	.327	.0159	.0193	.269	.296
AND10137-0701	.875	.375	.050	.094	.0790	.0995	.0009	.0087	.106	.332	
AND10137-0702		.500	.050		.0916	.146	.0020	.0110	.148	.347	
AND10137-0703		.625	.500	.063	.125	.115	.148	.0025	.0132	.144	.339
AND10137-0704			.625	.063		.131	.196	.0047	.0158	.190	.347
AND10137-0705		.625	.078	.158	.201	.0055	.0183	.187	.341		
AND10137-0706		.750	.750	.050	.094	.117	.245	.0065	.0151	.237	.360
AND10137-0707			.750	.063		.147	.247	.0079	.0184	.233	.354
AND10137-0708		1.000	.750	.078	.125	.177	.253	.0094	.0214	.230	.348
AND10137-0709			.750	.078		.216	.362	.0213	.0276	.314	.358
AND10137-0710			1.000	.125		.328	.379	.0304	.0378	.304	.339
AND10137-1001	1.000	.500	.063	.125	.123	.140	.0026	.0181	.144	.384	
AND10137-1002			.078		.148	.145	.0029	.0211	.141	.377	
AND10137-1003		.625	.063		.139	.187	.0049	.0216	.187	.394	
AND10137-1004			.078		.168	.193	.0058	.0252	.186	.388	
AND10137-1005		.750	.063		.155	.229	.0083	.0250	.231	.402	
AND10137-1006			.078		.187	.242	.0098	.0294	.229	.393	
AND10137-1007		.875	.094		.220	.248	.0113	.0335	.226	.390	
AND10137-1008			.063		.170	.289	.0128	.0285	.275	.409	
AND10137-1009		.078	.206		.294	.0152	.0335	.271	.403		
AND10137-1010		1.250	.094		.244	.300	.0176	.0383	.269	.397	
AND10137-1011			.078		.265	.460	.0417	.0460	.397	.417	
AND10137-1012		.125	.406		.478	.0607	.0643	.387	.398		
AND10137-1101	1.125	.500	.063	.125	.131	.134	.0027	.0241	.143	.429	
AND10137-1102			.078		.158	.139	.0031	.0281	.140	.422	
AND10137-1103		.625	.063		.147	.178	.0051	.0285	.186	.441	
AND10137-1104			.078		.177	.184	.0060	.0334	.184	.434	

PART MARKING AND DOCUMENTATION MAY BE EITHER AMS 10137 OR AND10137.

(For reference only)

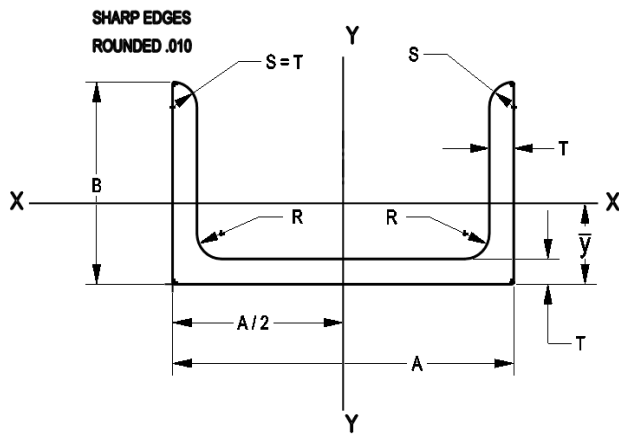

**Contact Us:**

Email: [sales@premier-metals.com](mailto:sales@premier-metals.com)

Phone: 310-532-6185

[www.premier-metals.com](http://www.premier-metals.com)



**NOTES ON SYMBOLS**

" $\bar{y}$ " = LOCATING DIMENSIONS FOR AXIS XX-YY.

$I_{xx}$  (and  $I_{yy}$ ) = MOMENT OF INERTIA ABOUT XX and YY.

$p_{xx}$  (and  $p_{yy}$ ) = RADIUS OF GYRATION ABOUT XX and YY.

	NOMINAL DIMENSIONS				AREA	SECTION ELEMENTS				
	A	B	T	R		$\bar{y}$	$I_{xx}$	$I_{yy}$	$p_{xx}$	$p_{yy}$
AND or AMS Extrusion Number	Inches				Square Inches	Inch	Inches <sup>4</sup>		Inch	
AND10137-1105	1.125	.750	.078	.125	.197	.232	.0102	.0388	.228	.444
AND10137-1106			.094		.232	.237	.0117	.0444	.225	.438
AND10137-1107			.063		.181	.278	.0135	.0379	.274	.458
AND10137-1108		.875	.078		.216	.283	.0158	.0441	.271	.452
AND10137-1109			.094		.256	.289	.0183	.0507	.268	.445
AND10137-1110			.125		.328	.298	.0225	.0616	.262	.433
AND10137-1111		1.000	.078		.236	.336	.0232	.0495	.314	.458
AND10137-1112			.094		.279	.341	.0269	.0569	.310	.452
AND10137-1113			.125		.359	.352	.0331	.0695	.303	.440
AND10137-1114			.094		.350	.508	.0661	.0757	.435	.466
AND10137-1115		1.375	.125		.453	.519	.0832	.0930	.428	.453
AND10137-1201	1.250	.625	.094	.125	.220	.181	.0071	.0493	.179	.473
AND10137-1202		.875	.094		.267	.278	.0190	.0650	.267	.493
AND10137-1203			.125		.344	.288	.0234	.0796	.261	.481
AND10137-1204		1.125	.078		.265	.377	.0334	.0698	.355	.513
AND10137-1205			.094		.314	.383	.0389	.0807	.352	.507
AND10137-1206			.125		.406	.393	.0484	.0994	.345	.495
AND10137-1207		1.500	.125		.500	.560	.1106	.1292	.470	.508
AND10137-1301	1.375	.625	.078	.125	.197	.169	.0063	.0540	.179	.524
AND10137-1302			.094		.232	.175	.0073	.0621	.177	.517
AND10137-1303		.875	.078		.236	.263	.0169	.0705	.268	.547
AND10137-1304			.094		.279	.268	.0198	.0818	.266	.543
AND10137-1305			.125		.359	.278	.0242	.1002	.259	.528
AND10137-1306		1.125	.094		.326	.371	.0403	.1010	.352	.557
AND10137-1307			.125		.422	.381	.0504	.1246	.346	.544
AND10137-1308			.156		.513	.390	.0591	.1451	.339	.532
AND10137-1309			1.625		.156	.668	.612	.1710	.2035	.506
AND10137-1401		1.500	.625		.094	.125	.244	.168	.0076	.0768
AND10137-1402	.125			.313	.178		.0090	.0939	.170	.548
AND10137-1403	.875		.125	.375	.269		.0249	.1236	.258	.574
AND10137-1404			.156	.455	.278		.0289	.1485	.267	.572
AND10137-1405			1.125	.094	.338		.360	.0414	.1233	.350

PART MARKING AND DOCUMENTATION MAY BE EITHER AMS 10137 OR AND10137.

(For reference only)

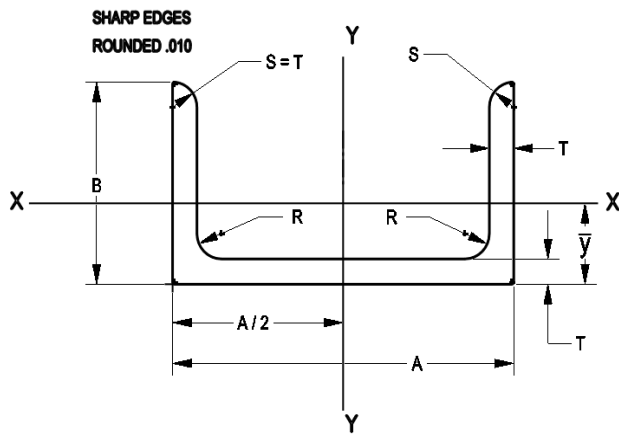

**Contact Us:**

Email: [sales@premier-metals.com](mailto:sales@premier-metals.com)

Phone: 310-532-6185

[www.premier-metals.com](http://www.premier-metals.com)



**NOTES ON SYMBOLS**

" $\bar{y}$ " = LOCATING DIMENSIONS FOR AXIS XX-YY.

$I_{xx}$  (and  $I_{yy}$ ) = MOMENT OF INERTIA ABOUT XX and YY.

$p_{xx}$  (and  $p_{yy}$ ) = RADIUS OF GYRATION ABOUT XX and YY.

	NOMINAL DIMENSIONS				AREA	SECTION ELEMENTS						
	A	B	T	R		$\bar{y}$	$I_{xx}$	$I_{yy}$	$p_{xx}$	$p_{yy}$		
AND or AMS Extrusion Number	Inches				Square Inches	Inch	Inches <sup>4</sup>		Inch			
AND10137-1406	1.500	1.125	.156	.125	.533	.379	.0610	.1791	.338	.580		
AND10137-1407		1.750	.156		.728	.654	.2176	.2675	.547	.606		
AND10137-1601	1.750	.750	.078	.125	.245	.194	.0117	.1104	.218	.671		
AND10137-1602			.094		.291	.199	.0135	.1280	.215	.664		
AND10137-1603		.875	.125		.406	.253	.0262	.1793	.254	.664		
AND10137-1604			.094		.338	.290	.0311	.1603	.304	.689		
AND10137-1605		1.000	.156		.533	.309	.0454	.2347	.292	.664		
AND10137-1606			.125		.500	.400	.0740	.2413	.385	.695		
AND10137-1607		1.250	.156		.611	.409	.0875	.2844	.379	.683		
AND10137-1608			.188		.728	.416	.1003	.3270	.371	.670		
AND10137-1609		1.500	.125		.563	.505	.1243	.2826	.470	.709		
AND10137-1610			.156		.689	.514	.1482	.3340	.464	.696		
AND10137-1611		2.000	.188		.822	.521	.1712	.3861	.456	.685		
AND10137-1612			.188		1.010	.742	.3916	.5000	.623	.704		
AND10137-2001		2.000	.750		.094	.125	.314	.187	.0140	.1768	.213	.750
AND10137-2002					.125		.406	.197	.0171	.2202	.205	.736
AND10137-2003	.156			.494	.207		.0198	.2583	.200	.723		
AND10137-2004	1.000		.094	.361	.274		.0324	.2194	.300	.779		
AND10137-2005			.125	.469	.284		.0405	.2752	.294	.766		
AND10137-2006			.156	.572	.293		.0474	.3247	.288	.754		
AND10137-2007	1.250		.125	.531	.380		.0774	.3302	.382	.788		
AND10137-2008			.156	.650	.389		.0916	.3912	.376	.776		
AND10137-2009	1.500		.125	.594	.482		.1302	.3852	.468	.806		
AND10137-2010			.156	.728	.491		.1553	.4576	.462	.793		
AND10137-2011	1.750		.156	.806	.598		.2410	.5241	.547	.807		
AND10137-2012			.188	.963	.604		.2802	.6071	.539	.794		
AND10137-2013	2.500		.188	1.250	.939		.7720	.8394	.787	.821		
AND10137-2201	2.250		1.000	.094	.125		.385	.261	.0336	.2898	.296	.868
AND10137-2202				.125			.500	.270	.0419	.3652	.290	.855
AND10137-2401	2.500		1.000	.094	.125		.408	.248	.0346	.3723	.291	.955
AND10137-2402				.125			.531	.258	.0432	.4706	.285	.941
AND10137-2403				.156			.650	.268	.0508	.5596	.280	.928

PART MARKING AND DOCUMENTATION MAY BE EITHER AMS 10137 OR AND10137.

(For reference only)

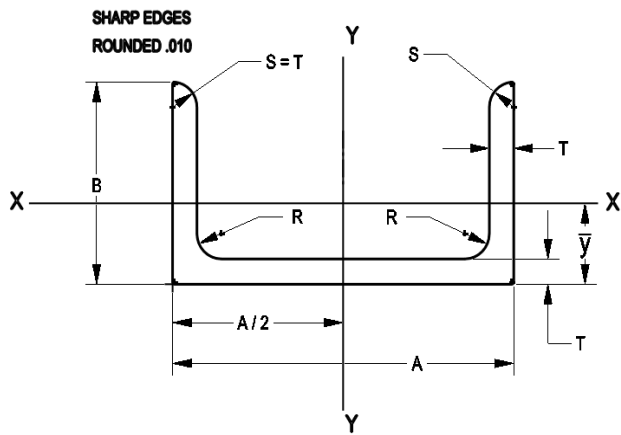

**Contact Us:**

Email: [sales@premier-metals.com](mailto:sales@premier-metals.com)

Phone: 310-532-6185

[www.premier-metals.com](http://www.premier-metals.com)



**NOTES ON SYMBOLS**

" $\bar{y}$ " = LOCATING DIMENSIONS FOR AXIS XX-YY.

$I_{xx}$  (and  $I_{yy}$ ) = MOMENT OF INERTIA ABOUT XX and YY.

$p_{xx}$  (and  $p_{yy}$ ) = RADIUS OF GYRATION ABOUT XX and YY.

AND or AMS Extrusion Number	NOMINAL DIMENSIONS				AREA Square Inches	SECTION ELEMENTS				
	A	B	T	R		$\bar{y}$ Inch	$I_{xx}$ Inches <sup>4</sup>	$I_{yy}$ Inches <sup>4</sup>	$p_{xx}$ Inch	$p_{yy}$ Inch
	Inches						Inches <sup>4</sup>		Inch	
AND10137-2404	2.500	1.375	.125	.125	.625	.394	.1093	.6030	.418	.982
AND10137-2405			.156		.767	.403	.1302	.7206	.412	.970
AND10137-2406			.188		.916	.411	.1500	.8398	.405	.957
AND10137-2407		1.750	.156	.125	.884	.552	.2605	.8935	.543	1.006
AND10137-2408			.188	.188	1.060	.559	.3029	1.027	.535	.986
AND10137-2601	2.750	1.000	.125	.125	.563	.247	.0444	.5931	.281	1.030
AND10137-2602			.156		.689	.257	.0522	.7069	.275	1.010
AND10137-3001	3.000	1.375	.156	.125	.845	.373	.1378	1.113	.404	1.150
AND10137-3002			.188	.188	1.010	.381	.1585	1.303	.396	1.140
AND10137-3003		1.750	.156	.125	.962	.514	.2767	1.349	.536	1.190
AND10137-3004			.188	.188	1.150	.521	.3217	1.582	.529	1.170

PART MARKING AND DOCUMENTATION MAY BE EITHER AMS 10137 OR AND10137.

(For reference only)